

- OCCUPIED
- RESERVED
- AVAILABLE

Last update 1<sup>st</sup> June 2026

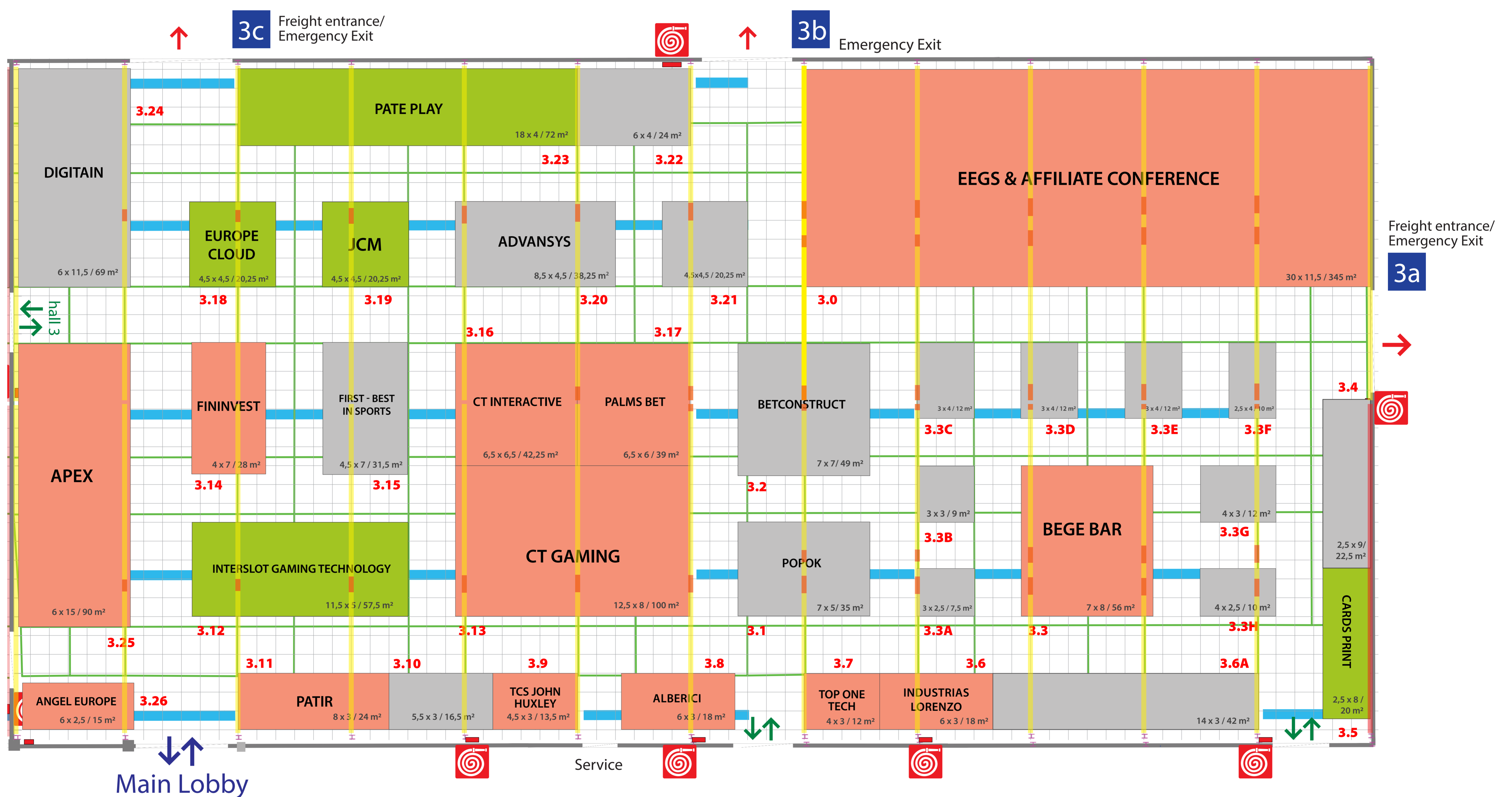

## CENTRAL FOYER

- Underground communications: electricity/mains, water supply, internet, air supply.
- Ceiling construction - 7,44m height.
- Main support structure - varying from 9,09m up to 10,64m height. Not available rigging points.
- Main support structure - varying from 9,09m up to 10,64m height. Rigging points - up to 300 kg per point according to Annex 1.
- Attention!  
Fire Plug and Emergency Exits must be free to access!